

**Nokia Customer Care  
RH-47 Series Cellular Phones**

**2 - Parts Lists & Component  
Layouts**

[This page intentionally blank]

**Table of Contents**

	<b>Page No</b>
Exploded View of Nokia RH-47 .....	4
Assembly parts list .....	6
Variant parts .....	7
Parts List for RH-47 Engine Module 1CJ_08.....	8
PWB components .....	8
Component layout diagram - bottom .....	27
Component layout diagram - top .....	28

[This page intentionally blank]

## Exploded View of Nokia RH-47

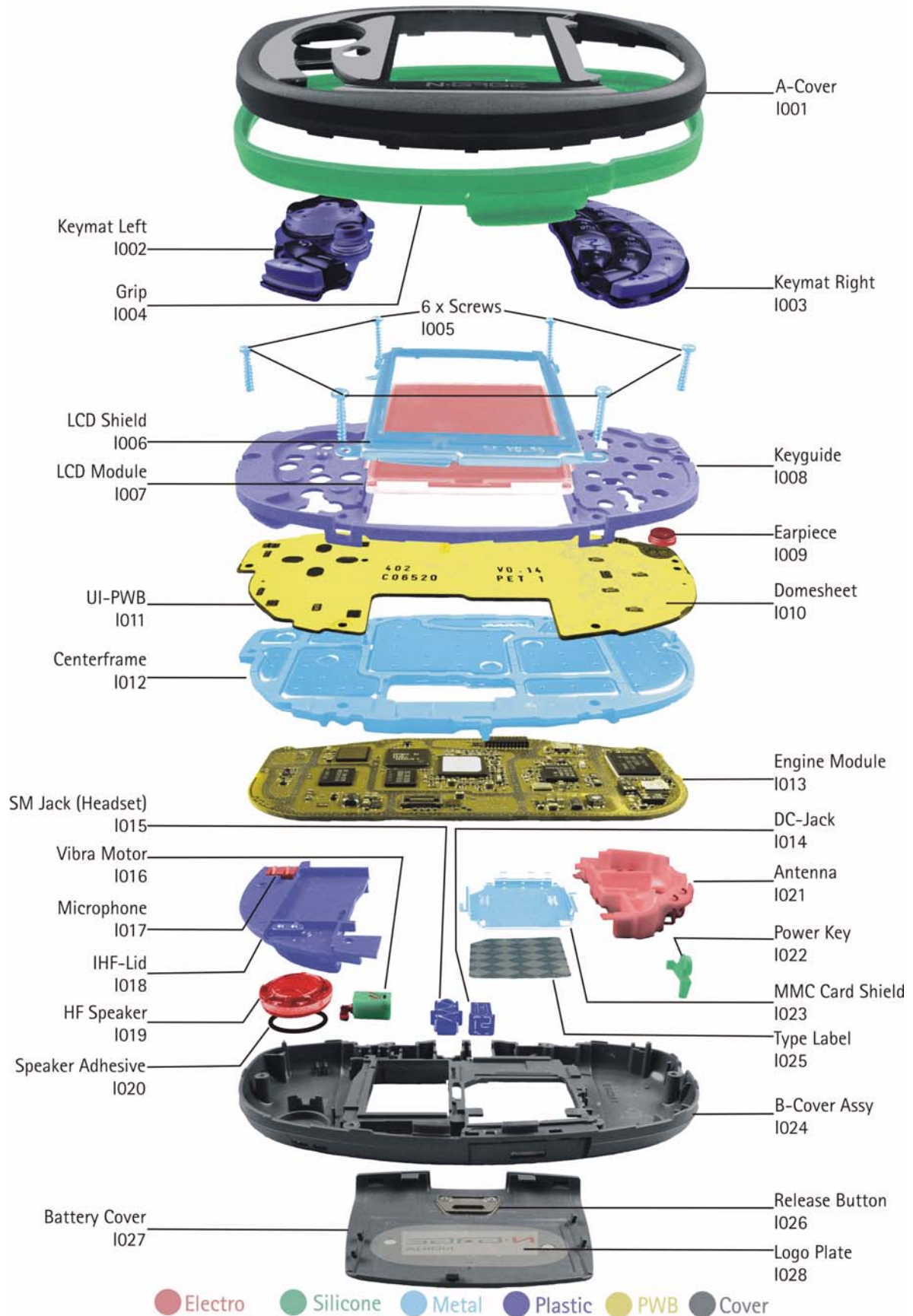

## Assembly parts list

ITEM / CIRCUIT REF.	QTY	NMP code	PART NAME
I001	1	(variants)	A-COVER ASSEMBLY
--	1	(variants)	KEYMAT ASSEMBLY
I002	1	(variants)	KEYMAT LEFT
I003	1	(variants)	KEYMAT RIGHT
I004	1	(variants)	GRIP
I005	6	6150071	SCREWS M1.8X11 TORX PLUS
I006	1	9511257	LCD-SHIELD
I007	1	4850817	LCD MODULE
I008	1	9460589	KEYGUIDE
I009	1	5140247	EARPIECE WITH GASKET
--	1	0202135	<b>UI PWB ASSEMBLY MODULE</b>
I010	1	--	DOMSHEET
I011	1	--	UI PWB
I012	1	9590240	CENTERFRAME ASSEMBLY
I013	1	0202349	ENGINE MODULE
I014	1	5400243	DC CONNECTOR JACK
I015	1	5409119	SM JACK (HEADSET)
I016	1	6800063	VIBRA MOTOR
--	1	9460587	IHF LID ASSY
I017	1	--	MICROPHONE
I018	1	--	IHF LID
I019	1	5140253	HF SPEAKER
I020	1	9480890	SPEAKER ADHESIVE
I021	1	0660313	ANTENNA-ASSY
I022	1	9491657	POWER SWITCH

I023	1	9511256	MMC CARD SHIELD
I024	1	9453384	B-COVER PRE-ASSEMBLY
I025	1	9381295	TYPE LABEL
--	1	9459320	BATTERY COVER ASSEMBLY
I026	1	--	RELEASE BUTTON
I027	1	--	BATTERY COVER
I028	1	--	LOGO PLATE

*Note: Item / reference codes to be used for fault reporting.*

### Variant parts

ITEM/ CIRCUIT REF.	QTY	PART NO	PART NAME
I001	1	9459631	A-COVER ASSY KHAKI COAL
I001	1	9491663	A-COVER ASSY ORANGE
I001	1	9459630	A-COVER ASSY PURPLE
(I002+I003)	1	0263234	Keymat assy orange
(I002+I003)	1	0263232	Keymat assy khaki coal
(I002+I003)	1	0263233	Keymat assy purple
(I002+I003)	1	0263324	Keymat assy khaki coal AWS
I002	1	9791285	Keymat left orange
I002	1	9791100	Keymat left khaki coal
I002	1	9791300	Keymat left purple
I002	1	9791100	Keymat left khaki coal AWS
I003	1	9791284	Keymat right orange
I003	1	9791101	Keymat right khaki coal
I003	1	9791299	Keymat right purple
I003	1	9791101	Keymat right khaki coal AWS
I004	1	9460646	GRIP LIGHT GRAY
I004	1	9460593	GRIP BLACK
I024	1	9453384	B-COVER PRE-ASSEMBLY

## Parts List for RH-47 Engine Module 1CJ\_08

### PWB components

Item	Code	Side	Grid	Ref	Type	Description and value		
B190	4510405	Top	M	4	CRYSTAL_FC_255	CRYSTAL 32.768KHZ+- 20PPM 12.5PF	32.768 kHz	~
B601	4510337	Top	O	4	CRYSTAL_TSX_8A_H0.95	CRYSTAL 26.0MHZ+-8PPM CL=15.5	26MHz	~
C100	2320805	Top	H	5	0402C	CHIPCAP X5R 100N K 10V 0402	100n	10V
C101	2320805	Top	J	8	0402C	CHIPCAP X5R 100N K 10V 0402	100n	10V
C102	2320805	Top	H	8	0402C	CHIPCAP X5R 100N K 10V 0402	100n	10V
C103	2320805	Top	I	5	0402C	CHIPCAP X5R 100N K 10V 0402	100n	10V
C104	2320805	Top	I	5	0402C	CHIPCAP X5R 100N K 10V 0402	100n	10V
C105	2320805	Top	I	8	0402C	CHIPCAP X5R 100N K 10V 0402	100n	10V
C106	2320805	Top	H	8	0402C	CHIPCAP X5R 100N K 10V 0402	100n	10V
C107	2320805	Top	H	8	0402C	CHIPCAP X5R 100N K 10V 0402	100n	10V
C108	2320805	Top	G	5	0402C	CHIPCAP X5R 100N K 10V 0402	100n	10V
C109	2320778	Top	G	8	0402C	Chipcap X7R 10% 16V 0402	10n	16V
C110	2320805	Top	I	5	0402C	CHIPCAP X5R 100N K 10V 0402	100n	10V
C111	2320805	Top	G	8	0402C	CHIPCAP X5R 100N K 10V 0402	100n	10V
C112	2320805	Top	G	5	0402C	CHIPCAP X5R 100N K 10V 0402	100n	10V
C113	2320744	Top	H	9	0402C	Chipcap X7R 10% 50V 0402	1n0	50V
C130	2312411	Top	O	2	1206_BLM	CHIPCAP X5R 1U0 M 25V 1206	1u0	25V



Item	Code	Side	Grid	Ref	Type	Description and value		
C131	2310037	Top	O	1	0805C	CHIPCAP X5R 10U M 6V3 0805	10U	6V3
C132	2320552	Top	O	1	0402C	Chipcap 5% NPO	47p	50V
C133	2312411	Top	O	2	1206_BLM	CHIPCAP X5R 1U0 M 25V 1206	1u0	25V
C134	2320544	Top	N	2	0402C	Chipcap 5% NPO	22p	50V
C139	2320536	Top	J	1	0402C	Chipcap 5% NPO	10p	50V
C140	2320536	Top	I	1	0402C	Chipcap 5% NPO	10p	50V
C141	2320805	Top	I	1	0402C	CHIPCAP X5R 100N K 10V 0402	100n	10V
C142	2320481	Top	J	2	0603C	CHIPCAP X5R 1U K 6V3 0603	1u0	6.3V
C143	2320544	Bottom	U	6	0402C	Chipcap 5% NPO	22p	50V
C144	2320805	Top	I	1	0402C	CHIPCAP X5R 100N K 10V 0402	100n	10V
C145	2320548	Bottom	G	8	0402C	Chipcap 5% NPO	33p	50V
C146	2320536	Bottom	G	8	0402C	Chipcap 5% NPO	10p	50V
C147	2320548	Bottom	G	8	0402C	Chipcap 5% NPO	33p	50V
C149	2320778	Bottom	G	8	0402C	Chipcap X7R 10% 16V 0402	10n	16V
C161	2320544	Top	K	9	0402C	Chipcap 5% NPO	22p	50V
C170	2320536	Top	G	9	0402C	Chipcap 5% NPO	10p	50V
C190	2320778	Top	L	6	0402C	Chipcap X7R 10% 16V 0402	10n	16V
C191	2320805	Top	L	4	0402C	CHIPCAP X5R 100N K 10V 0402	100n	10V
C192	2320805	Top	J	7	0402C	CHIPCAP X5R 100N K 10V 0402	100n	10V
C193	2320805	Top	L	4	0402C	CHIPCAP X5R 100N K 10V 0402	100n	10V
C194	2320805	Top	J	7	0402C	CHIPCAP X5R 100N K 10V 0402	100n	10V
C195	2320805	Top	M	7	0402C	CHIPCAP X5R 100N K 10V 0402	100n	10V
C196	2320805	Top	I	5	0402C	CHIPCAP X5R 100N K 10V 0402	100n	10V
C197	2320805	Top	I	5	0402C	CHIPCAP X5R 100N K 10V 0402	100n	10V

Item	Code	Side	Grid	Ref	Type	Description and value		
C198	2320805	Top	L	7	0402C	CHIPCAP X5R 100N K 10V 0402	100n	10V
C199	2320536	Top	L	5	0402C	Chipcap 5% NPO	10p	50V
C200	2320536	Top	L	4	0402C	Chipcap 5% NPO	10p	50V
C201	2320744	Top	J	4	0402C	Chipcap X7R 10% 50V 0402	1n0	50V
C202	2320481	Top	K	7	0603C	CHIPCAP X5R 1U K 6V3 0603	1u0	6.3V
C203	2320481	Top	J	8	0603C	CHIPCAP X5R 1U K 6V3 0603	1u0	6.3V
C204	2320481	Top	J	7	0603C	CHIPCAP X5R 1U K 6V3 0603	1u0	6.3V
C205	2320481	Top	J	7	0603C	CHIPCAP X5R 1U K 6V3 0603	1u0	6.3V
C206	2320805	Top	K	7	0402C	CHIPCAP X5R 100N K 10V 0402	100n	10V
C207	2320481	Top	K	8	0603C	CHIPCAP X5R 1U K 6V3 0603	1u0	6.3V
C208	2320481	Top	L	8	0603C	CHIPCAP X5R 1U K 6V3 0603	1u0	6.3V
C210	2320481	Top	M	5	0603C	CHIPCAP X5R 1U K 6V3 0603	1u0	6.3V
C211	2320481	Top	L	7	0603C	CHIPCAP X5R 1U K 6V3 0603	1u0	6.3V
C212	2320481	Top	M	5	0603C	CHIPCAP X5R 1U K 6V3 0603	1u0	6.3V
C213	2320481	Top	M	6	0603C	CHIPCAP X5R 1U K 6V3 0603	1u0	6.3V
C214	2320481	Top	M	7	0603C	CHIPCAP X5R 1U K 6V3 0603	1u0	6.3V
C215	2320481	Top	M	7	0603C	CHIPCAP X5R 1U K 6V3 0603	1u0	6.3V
C216	2320481	Top	J	4	0603C	CHIPCAP X5R 1U K 6V3 0603	1u0	6.3V
C217	2320481	Top	M	7	0603C	CHIPCAP X5R 1U K 6V3 0603	1u0	6.3V
C219	2320481	Top	L	5	0603C	CHIPCAP X5R 1U K 6V3 0603	1u0	6.3V
C220	2320481	Top	L	5	0603C	CHIPCAP X5R 1U K 6V3 0603	1u0	6.3V

Item	Code	Side	Grid	Ref	Type	Description and value		
C221	2320481	Top	M	7	0603C	CHIPCAP X5R 1U K 6V3 0603	1u0	6.3V
C222	2320481	Top	M	6	0603C	CHIPCAP X5R 1U K 6V3 0603	1u0	6.3V
C223	2320481	Top	L	7	0603C	CHIPCAP X5R 1U K 6V3 0603	1u0	6.3V
C224	2320481	Top	J	4	0603C	CHIPCAP X5R 1U K 6V3 0603	1u0	6.3V
C225	2320481	Top	K	4	0603C	CHIPCAP X5R 1U K 6V3 0603	1u0	6.3V
C226	2320481	Top	I	5	0603C	CHIPCAP X5R 1U K 6V3 0603	1u0	6.3V
C227	2320481	Top	M	4	0603C	CHIPCAP X5R 1U K 6V3 0603	1u0	6.3V
C228	2320481	Top	M	5	0603C	CHIPCAP X5R 1U K 6V3 0603	1u0	6.3V
C229	2320481	Top	M	4	0603C	CHIPCAP X5R 1U K 6V3 0603	1u0	6.3V
C230	2320778	Top	J	4	0402C	Chipcap X7R 10% 16V 0402	10n	16V
C231	2320778	Top	J	4	0402C	Chipcap X7R 10% 16V 0402	10n	16V
C232	2320544	Top	I	4	0402C	Chipcap 5% NPO	22p	50V
C261	2310037	Top	F	2	0805C	CHIPCAP X5R 10U M 6V3 0805	10U	6V3
C262	2310037	Top	F	2	0805C	CHIPCAP X5R 10U M 6V3 0805	10U	6V3
C263	2310037	Top	G	2	0805C	CHIPCAP X5R 10U M 6V3 0805	10U	6V3
C265	2320552	Top	E	1	0402C	Chipcap 5% NPO	47p	50V
C300	2320481	Top	L	7	0603C	CHIPCAP X5R 1U K 6V3 0603	1u0	6.3V
C301	2320481	Top	K	7	0603C	CHIPCAP X5R 1U K 6V3 0603	1u0	6.3V
C302	2310037	Top	K	7	0805C	CHIPCAP X5R 10U M 6V3 0805	10U	6V3
C310	2320805	Top	I	4	0402C	CHIPCAP X5R 100N K 10V 0402	100n	10V
C311	2320805	Top	I	5	0402C	CHIPCAP X5R 100N K 10V 0402	100n	10V

Item	Code	Side	Grid	Ref	Type	Description and value		
C312	2320779	Top	I	4	0603_BLM	CHIPCAP X7R 100N K 16V 0603	100n	16V
C313	2320805	Top	C	5	0402C	CHIPCAP X5R 100N K 10V 0402	100n	10V
C314	2320805	Top	C	5	0402C	CHIPCAP X5R 100N K 10V 0402	100n	10V
C315	2320805	Top	D	7	0402C	CHIPCAP X5R 100N K 10V 0402	100n	10V
C316	2320805	Top	D	7	0402C	CHIPCAP X5R 100N K 10V 0402	100n	10V
C317	2320779	Top	D	7	0603_BLM	CHIPCAP X7R 100N K 16V 0603	100n	16V
C318	2320778	Top	D	8	0402C	Chipcap X7R 10% 16V 0402	10n	16V
C319	2320778	Top	D	8	0402C	Chipcap X7R 10% 16V 0402	10n	16V
C320	2320778	Top	D	7	0402C	Chipcap X7R 10% 16V 0402	10n	16V
C321	2320481	Top	D	8	0603C	CHIPCAP X5R 1U K 6V3 0603	1u0	6.3V
C325	2320544	Top	L	4	0402C	Chipcap 5% NPO	22p	50V
C330	2320481	Top	B	6	0603C	CHIPCAP X5R 1U K 6V3 0603	1u0	6.3V
C331	2320783	Top	C	6	0402C	CHIPCAP X7R 33N K 10V 0402	33n	10V
C332	2320783	Top	B	6	0402C	CHIPCAP X7R 33N K 10V 0402	33n	10V
C334	2320572	Top	B	5	0402C	Chipcap 5% X7R	330p	50V
C335	2320778	Top	B	5	0402C	Chipcap X7R 10% 16V 0402	10n	16V
C336	2320744	Top	L	3	0402C	Chipcap X7R 10% 50V 0402	1n0	50V
C337	2315209	Top	L	4	0405_2_PO.65 _AVX	CHIP ARRAY X5R 2X33N M 10V 0405	2x33n	10V
C339	2320764	Top	K	4	0402C	Chipcap X7R 10% 25V 0402	6n8	25V
C340	2320764	Top	L	4	0402C	Chipcap X7R 10% 25V 0402	6n8	25V

Item	Code	Side	Grid	Ref	Type	Description and value		
C341	2310037	Top	L	4	0805C	CHIPCAP X5R 10U M 6V3 0805	10U	6V3
C344	2315209	Top	K	4	0405_2_P0.65 _AVX	CHIP ARRAY X5R 2X33N M 10V 0405	2x33n	10V
C346	2320764	Top	K	4	0402C	Chipcap X7R 10% 25V 0402	6n8	25V
C347	2320764	Top	K	4	0402C	Chipcap X7R 10% 25V 0402	6n8	25V
C348	2310037	Top	J	4	0805C	CHIPCAP X5R 10U M 6V3 0805	10U	6V3
C349	2320544	Bottom	B	7	0402C	Chipcap 5% NPO	22p	50V
C350	2315213	Bottom	B	6	0405_2_P0.65	CHIP ARRAY NPO 2X22P K 25V 0405	2x22p	25V
C352	2310037	Top	B	4	0805C	CHIPCAP X5R 10U M 6V3 0805	10U	6V3
C353	2320544	Bottom	D	1	0402C	Chipcap 5% NPO	22p	50V
C355	2315213	Bottom	D	1	0405_2_P0.65	CHIP ARRAY NPO 2X22P K 25V 0405	2x22p	25V
C356	2320787	Top	B	5	0402C	CHIPCAP X7R 15N K 16V 0402	15n	16V
C357	2320560	Top	B	5	0402C	Chipcap 5% NPO	100p	50V
C358	2320544	Top	L	4	0402C	Chipcap 5% NPO	22p	50V
C359	2320544	Top	K	4	0402C	Chipcap 5% NPO	22p	50V
C380	2320481	Bottom	Q	1	0603C	CHIPCAP X5R 1U K 6V3 0603	1u0	6.3V
C381	2320544	Bottom	R	2	0402C	Chipcap 5% NPO	22p	50V
C382	2320544	Bottom	M	9	0402C	Chipcap 5% NPO	22p	50V
C383	2320544	Bottom	K	8	0402C	Chipcap 5% NPO	22p	50V
C384	2315213	Bottom	K	8	0405_2_P0.65	CHIP ARRAY NPO 2X22P K 25V 0405	2x22p	25V
C385	2315213	Bottom	K	7	0405_2_P0.65	CHIP ARRAY NPO 2X22P K 25V 0405	2x22p	25V
C386	2315255	Bottom	I	10	0405_2_P0.65	CHIP ARRAY X5R 2X1N K 16V 0405	2x1n	16V
C389	2320778	Bottom	M	9	0402C	Chipcap X7R 10% 16V 0402	10n	16V
C390	2320536	Bottom	R	2	0402C	Chipcap 5% NPO	10p	50V

Item	Code	Side	Grid	Ref	Type	Description and value		
C391	2320552	Bottom	R	2	0402C	Chipcap 5% NPO	47p	50V
C430	2320544	Bottom	D	8	0402C	Chipcap 5% NPO	22p	50V
C431	2320481	Top	E	3	0603C	CHIPCAP X5R 1U K 6V3 0603	1u0	6.3V
C432	2320481	Top	F	3	0603C	CHIPCAP X5R 1U K 6V3 0603	1u0	6.3V
C433	2320481	Bottom	D	8	0603C	CHIPCAP X5R 1U K 6V3 0603	1u0	6.3V
C434	2320544	Top	F	3	0402C	Chipcap 5% NPO	22p	50V
C435	2320544	Top	E	3	0402C	Chipcap 5% NPO	22p	50V
C470	2320805	Bottom	K	1	0402C	CHIPCAP X5R 100N K 10V 0402	100n	10V
C471	2320778	Bottom	L	7	0402C	Chipcap X7R 10% 16V 0402	10n	16V
C472	2320481	Bottom	M	7	0603C	CHIPCAP X5R 1U K 6V3 0603	1u0	6.3V
C473	2320805	Bottom	M	6	0402C	CHIPCAP X5R 100N K 10V 0402	100n	10V
C474	2320481	Bottom	M	7	0603C	CHIPCAP X5R 1U K 6V3 0603	1u0	6.3V
C475	2320481	Bottom	M	7	0603C	CHIPCAP X5R 1U K 6V3 0603	1u0	6.3V
C476	2320522	Top	H	1	0402C	Chipcap +-0.25pF NPO	2p7	50V
C477	2320522	Bottom	H	8	0402C	Chipcap +-0.25pF NPO	2p7	50V
C492	2320544	Bottom	L	7	0402C	Chipcap 5% NPO	22p	50V
C602	2320546	Top	N	4	0402C	Chipcap 5% NPO	27p	50V
C603	2320744	Top	O	3	0402C	Chipcap X7R 10% 50V 0402	1n0	50V
C604	2320629	Top	Q	5	0402C	CHIPCAP NPO 1P0 B 50V 0402	1p0	50V
C605	2320805	Top	Q	3	0402C	CHIPCAP X5R 100N K 10V 0402	100n	10V
C606	2320546	Top	Q	3	0402C	Chipcap 5% NPO	27p	50V
C607	2310037	Top	Q	3	0805C	CHIPCAP X5R 10U M 6V3 0805	10U	6V3
C610	2320805	Top	R	8	0402C	CHIPCAP X5R 100N K 10V 0402	100n	10V

Item	Code	Side	Grid	Ref	Type	Description and value		
C615	2320778	Top	P	3	0402C	Chipcap X7R 10% 16V 0402	10n	16V
C620	2320546	Top	P	4	0402C	Chipcap 5% NPO	27p	50V
C622	2320805	Top	Q	6	0402C	CHIPCAP X5R 100N K 10V 0402	100n	10V
C623	2320805	Top	O	5	0402C	CHIPCAP X5R 100N K 10V 0402	100n	10V
C624	2320546	Top	O	6	0402C	Chipcap 5% NPO	27p	50V
C625	2320481	Top	N	5	0603C	CHIPCAP X5R 1U K 6V3 0603	1u0	6.3V
C626	2320522	Top	P	6	0402C	Chipcap +-0.25pF NPO	2p7	50V
C627	2310037	Top	Q	7	0805C	CHIPCAP X5R 10U M 6V3 0805	10U	6V3
C628	2320805	Top	O	4	0402C	CHIPCAP X5R 100N K 10V 0402	100n	10V
C629	2320546	Top	O	5	0402C	Chipcap 5% NPO	27p	50V
C632	2320744	Top	P	4	0402C	Chipcap X7R 10% 50V 0402	1n0	50V
C634	2320514	Top	Q	4	0402C	Chipcap +-0.25pF NPO	1p2	50V
C650	2320618	Top	O	5	0402C	Chipcap X7R 5% 25V 0402	4n7	25V
C706	2320564	Top	O	6	0402C	Chipcap 5% NPO	150p	50V
C710	2321013	Top	O	8	0402C	CHIPCAP NPO 270P J 25V 0402	270p	25V
C711	2420031	Top	P	8	0603C	CHIPCAP PPS 2N7 G 16V 0603	2n7	16V
C712	2320631	Top	P	8	0402C	CHIPCAP NPO 180P J 25V 0402	180p	25V
C715	2320558	Top	O	6	0402C	Chipcap 5% NPO	82p	50V
C716	2320558	Top	O	6	0402C	Chipcap 5% NPO	82p	50V
C717	2320546	Top	N	6	0402C	Chipcap 5% NPO	27p	50V
C718	2320744	Top	N	6	0402C	Chipcap X7R 10% 50V 0402	1n0	50V
C721	2320744	Top	Q	6	0402C	Chipcap X7R 10% 50V 0402	1n0	50V
C722	2320540	Top	Q	6	0402C	Chipcap 5% NPO	15p	50V

Item	Code	Side	Grid	Ref	Type	Description and value		
C731	2320546	Top	P	6	0402C	Chipcap 5% NPO	27p	50V
C734	2320514	Top	Q	6	0402C	Chipcap +-0.25pF NPO	1p2	50V
C735	2320514	Top	Q	5	0402C	Chipcap +-0.25pF NPO	1p2	50V
C740	2310037	Top	Q	8	0805C	CHIPCAP X5R 10U M 6V3 0805	10U	6V3
C741	2320602	Top	Q	8	0402C	Chipcap +-0.25pF NPO	4p7	50V
C742	2320629	Top	T	3	0402C	CHIPCAP NPO 1P0 B 50V 0402	1p0	50V
C743	2320629	Top	T	3	0402C	CHIPCAP NPO 1P0 B 50V 0402	1p0	50V
C803	2320546	Top	U	4	0402C	Chipcap 5% NPO	27p	50V
C804	2320552	Top	U	4	0402C	Chipcap 5% NPO	47p	50V
C805	2320546	Top	U	3	0402C	Chipcap 5% NPO	27p	50V
C818	2320548	Top	T	8	0402C	Chipcap 5% NPO	33p	50V
C820	2320546	Top	U	8	0402C	Chipcap 5% NPO	27p	50V
C821	2320518	Top	U	8	0402C	Chipcap +-0.25pF NPO	1p8	50V
C826	2320534	Top	S	4	0402C	Chipcap +-0.25pF NPO	8p2	50V
C831	2322023	Top	O	6	0603C	CHIPCAP NPO 2N2 J 16V 0603	2n2	16V
C838	2320514	Top	U	5	0402C	Chipcap +-0.25pF NPO	1p2	50V
C871	2320805	Top	P	4	0402C	CHIPCAP X5R 100N K 10V 0402	100n	10V
C873	2320744	Top	T	5	0402C	Chipcap X7R 10% 50V 0402	1n0	50V
C874	2320602	Top	T	5	0402C	Chipcap +-0.25pF NPO	4p7	50V
C876	2320744	Top	S	8	0402C	Chipcap X7R 10% 50V 0402	1n0	50V
C877	2320548	Top	T	5	0402C	Chipcap 5% NPO	33p	50V
C878	2320536	Top	T	5	0402C	Chipcap 5% NPO	10p	50V
C880	2310037	Top	T	5	0805C	CHIPCAP X5R 10U M 6V3 0805	10U	6V3



Item	Code	Side	Grid	Ref	Type	Description and value		
C891	2320921	Top	S	8	0402C_AVX	CHIPCAP NP0 HQ 3P9 J 16V 0402	3p9	16V
D100	4377007	Top	H	7	CSP_240	UPP_WD2-V3.2E F751748B UBGA240	~	~
D130	4341309	Top	P	1	SOT23L_8	DC/DC CONV 350MA TK11851 SSOP8	~	~
D190	4370825	Top	K	6	uBGA168	UEMK 4.4 W-DOG ENA TO21 TFBGA168	~	~
D310	4347033	Top	E	8	WBGA_60_9.4 X8.6_H0.9	SDRAM 8MX16 1.8V/1.8V WBGA60	8Mx16	~
D311	4347041	Top	E	5	PBFREEBGA40 _128MB_54M HZ_MAX	FLASH NMP DCT4 128MBIT 54MHZ PBFREE	8Mx16	~
D312	4347113	Top	H	4	PBFREEBGA40 _64MB_54MH Z_MAX	FLASH NMP DCT4 64MBIT 54MHZ PBFREE	4Mx16	~
F380	5119029	Bottom	M	10	0603_FUSE	SM FUSE F 1.5A 32V ROHS-FREE 0603	1.5A	~
G190	4700141	Bottom	Q	9	BATTER_RB414 H	CELL CAPACITOR 0.01MAH 3V3	3V3	~
G701	4350431	Top	P	8	VCO_FDK_IT_4	VCO 3296- 3980MHZ FOUR 2.7V 20MA	3296- 3980M Hz	~
L130	3640149	Top	Q	2	CHOKE_ELL4L M100MN2	CHOKE 15U M 0.5A 4X4X1.8	15uH	~
L131	3203741	Top	N	1	0603_BLM	FERRITE BEAD OR5 600R/100MHZ 0603	600R/ 100MH z	~
L190	3203741	Top	L	6	0603_BLM	FERRITE BEAD OR5 600R/100MHZ 0603	600R/ 100MH z	~
L260	3640151	Top	F	2	CHOKE_ELL4L M100MN2	CHOKE 10U M 0.6A OR18 4X4X1.8	10uH	~
L261	3203741	Top	F	1	0603_BLM	FERRITE BEAD OR5 600R/100MHZ 0603	600R/ 100MH z	~

Item	Code	Side	Grid	Ref	Type	Description and value		
L330	3203743	Top	B	4	0805_BLM21	FERR.BEAD 0R03 42R/100MHZ 3A 0805	42R/ 100MH z	~
L331	3203801	Top	L	4	0405_2_MATS U	CHIP BEAD ARRAY 2X1000R 0405	2x1000 R/ 100MH z	~
L380	3203743	Bottom	M	9	0805_BLM21	FERR.BEAD 0R03 42R/100MHZ 3A 0805	42R/ 100MH z	~
L381	3203801	Bottom	K	8	0405_2_MATS U	CHIP BEAD ARRAY 2X1000R 0405	2x1000 R/ 100MH z	~
L382	3203801	Bottom	I	9	0405_2_MATS U	CHIP BEAD ARRAY 2X1000R 0405	2x1000 R/ 100MH z	~
L384	3203741	Bottom	I	8	0603_BLM	FERRITE BEAD 0R5 600R/100MHZ 0603	600R/ 100MH z	~
L430	3203741	Top	F	3	0603_BLM	FERRITE BEAD 0R5 600R/100MHZ 0603	600R/ 100MH z	~
L431	3203741	Top	E	3	0603_BLM	FERRITE BEAD 0R5 600R/100MHZ 0603	600R/ 100MH z	~
L606	3646229	Top	Q	4	0402_ELJRF	CHIP COIL 10N J Q7/100M 0402	10nH	~
L607	3646229	Top	Q	4	0402_ELJRF	CHIP COIL 10N J Q7/100M 0402	10nH	~
L608	3646005	Top	Q	5	0402L	CHIP COIL 2N7+- 0N3 Q29/800M 0402	2n7H	~
L609	3646005	Top	Q	4	0402L	CHIP COIL 2N7+- 0N3 Q29/800M 0402	2n7H	~
L610	3646051	Top	T	3	0402L	CHIP COIL 3N9 +- 0N3 Q28/800M 0402	3n9H	~
L701	3646069	Top	O	4	0402L	CHIP COIL 33N J Q23/800M 0402	33nH	~
L703	3646069	Top	N	4	0402L	CHIP COIL 33N J Q23/800M 0402	33nH	~

Item	Code	Side	Grid	Ref	Type	Description and value		
L705	3646047	Top	Q	5	0402L	CHIP COIL 3N3 +- ON3 Q28/800M 0402	3n3H	~
L706	3646061	Top	P	6	0402L	CHIP COIL 15N J Q30/800M 0402	15nH	~
L707	3646069	Top	P	6	0402L	CHIP COIL 33N J Q23/800M 0402	33nH	~
L708	3646069	Top	Q	6	0402L	CHIP COIL 33N J Q23/800M 0402	33nH	~
L712	3646053	Top	R	6	0402L	CHIP COIL 4N7 +- ON3 Q28/800M 0402	4n7H	~
L730	3203757	Top	R	8	0402L	FERRITE BEAD OR25 120R/ 100MHZ 0402	120R/ 100MH z	~
L801	4550197	Top	T	4	COUPLER_LDC 15D	DIR.COULER 850/ 1800/1900 2.1X1.35	850/ 1800/ 1900M HZ	~
L806	3646229	Top	T	8	0402_ELJRF	CHIP COIL 10N J Q7/100M 0402	10nH	~
L824	3646229	Top	T	8	0402_ELJRF	CHIP COIL 10N J Q7/100M 0402	10nH	~
L850	3203743	Top	S	4	0805_BLM21	FERR.BEAD OR03 42R/100MHZ 3A 0805	42R/ 100MH z	~
N260	4341711	Top	G	2	USMD10_2.53 4X2.28X0.675	DC/DC 1.8V/1.5V LM2608-1.8 USMD10	~	~
N330	4342429	Top	B	5	USMD9_1.544 X1.544_0.675	AF AMP 0.4W LM4890/NCP2890 PBFREE	~	~
N380	4341705	Bottom	Q	1	USMD10_2.08 X1.57_H0.675	CURRENT SENS LM3820 USMD10 PB-FREE	~	~
N430	700085	Bottom	D	5	BT102i_X_BLU ETOOTH	BLUETOOTH LRB-4 MODULE D560	~	~
N470	4341761	Bottom	M	7	USMD16_2.03 X2.03	VREG & LEVEL SHIFT LP3928 USMD16	~	2.8V
N601	4380013	Top	P	5	LFBGA_80	MJOLNER RF ASIC PMB3347 LFBGA80	~	~

Item	Code	Side	Grid	Ref	Type	Description and value		
N801	4350403	Top	T	6	RF3132	PW AMP GSM850/ 1900 35DBM 3.5V	~	~
R100	1430786	Top	I	5	0402R	Resistor 5% 63mW	18k	~
R101	1430718	Top	G	7	0402R	Resistor 5% 63mW	47R	~
R130	1430714	Top	N	2	0402R	Resistor 5% 63mW	33R	~
R135	1430700	Top	I	2	0402R	Resistor 5% 63mW	10R	~
R140	1430770	Bottom	U	6	0402R	Resistor 5% 63mW	4k7	~
R141	1430691	Top	Q	1	0402R	CHIPRES 0W06 2R2 J 0402	2R2	~
R142	1825133	Top	I	2	0402_VAR	CHIP VARISTOR VWM14V VC50V 0402	14V/ 50V	~
R143	1825133	Top	H	2	0402_VAR	CHIP VARISTOR VWM14V VC50V 0402	14V/ 50V	~
R144	1430762	Top	I	2	0402R	Resistor 5% 63mW	2k2	~
R160	1430720	Top	K	10	0402R	Resistor 5% 63mW	56R	~
R162	1430754	Top	L	9	0402R	Resistor 5% 63mW	1k0	~
R170	1430726	Top	G	8	0402R	Resistor 5% 63mW	100R	~
R190	1419003	Top	M	6	1210_R	CHIPRES 0W5 0R22 J 1210	0R22	~
R193	1620043	Top	J	3	EXB28V_SR	RES NETWORK 0W03 4X100K J 0804	4x100k	~
R199	1820039	Top	K	2	0402_NTH5	NTC RES 47K J B=4050+-3% 0402	47k	~
R200	1430770	Top	J	4	0402R	Resistor 5% 63mW	4k7	~
R310	1430770	Top	I	4	0402R	Resistor 5% 63mW	4k7	~
R330	1430788	Top	C	5	0402R	Resistor 5% 63mW	22k	~

Item	Code	Side	Grid	Ref	Type	Description and value		
R331	1430788	Top	B	5	0402R	Resistor 5% 63mW	22k	~
R332	1430790	Top	B	5	0402R	Resistor 5% 63mW	27k	~
R333	1430790	Top	C	5	0402R	Resistor 5% 63mW	27k	~
R334	1430778	Top	L	3	0402R	Resistor 5% 63mW	10k	~
R335	1620105	Top	L	3	MNR02	RES NETWORK 0W06 2X2k2 J 0404	2x2k2	~
R336	1430792	Top	K	4	0402R	Resistor 5% 63mW	33k	~
R337	1620031	Top	L	3	0404_R_SR	RES NETWORK 0W06 2X1K0 J 0404	2x1k0	~
R338	1620105	Top	K	4	MNR02	RES NETWORK 0W06 2X2k2 J 0404	2x2k2	~
R339	1620031	Top	K	3	0404_R_SR	RES NETWORK 0W06 2X1K0 J 0404	2x1k0	~
R340	1430792	Top	K	4	0402R	Resistor 5% 63mW	33k	~
R344	1825031	Bottom	B	6	0405_2	VARISTOR ARRAY 2XVWM16V VC50 0405	2XVW M16V	16V
R346	1825031	Bottom	E	1	0405_2	VARISTOR ARRAY 2XVWM16V VC50 0405	2XVW M16V	16V
R347	1430710	Top	B	5	0402R	Resistor 5% 63mW	22R	~
R349	1430734	Top	L	4	0402R	Resistor 5% 63mW	220R	~
R350	1430734	Top	K	4	0402R	Resistor 5% 63mW	220R	~
R351	1620105	Top	K	4	MNR02	RES NETWORK 0W06 2X2k2 J 0404	2x2k2	~
R352	1620105	Top	K	4	MNR02	RES NETWORK 0W06 2X2k2 J 0404	2x2k2	~

Item	Code	Side	Grid	Ref	Type	Description and value		
R381	4129011	Bottom	R	2	uBGA5	ASIP 4XESD **PB-FREE** BGA5	~	~
R382	1430812	Top	M	4	0402R	Resistor 5% 63mW	220k	~
R384	1430762	Bottom	Q	1	0402R	Resistor 5% 63mW	2k2	~
R385	1430762	Bottom	Q	1	0402R	Resistor 5% 63mW	2k2	~
R386	1430693	Bottom	I	9	0402R	Chipres 0W06 5R6 J 0402	5R6	~
R387	1825031	Bottom	K	7	0405_2	VARISTOR ARRAY 2XVWM16V VC50 0405	2XVW M16V	16V
R388	1825031	Bottom	I	9	0405_2	VARISTOR ARRAY 2XVWM16V VC50 0405	2XVW M16V	16V
R389	1430693	Bottom	I	9	0402R	Chipres 0W06 5R6 J 0402	5R6	~
R390	1820039	Bottom	P	2	0402_NTH5	NTC RES 47K J B=4050+-3% 0402	47k	~
R392	1825133	Bottom	I	8	0402_VAR	CHIP VARISTOR VWM14V VC50V 0402	14V/ 50V	~
R435	1430700	Bottom	C	8	0402R	Resistor 5% 63mW	10R	~
R470	4129071	Bottom	K	1	uBGA8	ASIP EMIF03- SIM01F2 **PB- FREE**	~	~
R473	4129101	Bottom	N	7	uBGA11_1.62X 2.12	ASIP EMIF04- MMC02F2**PB- FREE**	~	~
R601	1430754	Top	N	3	0402R	Resistor 5% 63mW	1k0	~
R602	1430764	Top	N	4	0402R	Resistor 5% 63mW	3k3	~
R603	1430758	Top	N	3	0402R	Resistor 5% 63mW	1k5	~
R605	1430812	Top	N	5	0402R	Resistor 5% 63mW	220k	~
R610	1430712	Top	Q	3	0402R	Resistor 5% 63mW	27R	~

Item	Code	Side	Grid	Ref	Type	Description and value		
R612	1430754	Top	P	3	0402R	Resistor 5% 63mW	1k0	~
R623	1430726	Top	N	5	0402R	Resistor 5% 63mW	100R	~
R626	1430846	Top	O	3	0402R	Resistor 1% 63mW	2k7	~
R627	1430718	Top	N	3	0402R	Resistor 5% 63mW	47R	~
R630	1430718	Top	O	4	0402R	Resistor 5% 63mW	47R	~
R706	1430788	Top	O	6	0402R	Resistor 5% 63mW	22k	~
R707	1430780	Top	O	6	0402R	Resistor 5% 63mW	12k	~
R708	1430774	Top	N	6	0402R	Resistor 5% 63mW	6k8	~
R710	1430841	Top	O	8	0402R	Chipres 0W06 6k8 F 0402	6k8	~
R711	1430865	Top	P	8	0402R	CHIPRES 0W06 5K6 F 0402	5k6	~
R715	1620033	Top	O	7	0404_R_SR	RES NETWORK 0W06 2X5K6 J 0404	2x5k6	~
R716	1620033	Top	O	7	0404_R_SR	RES NETWORK 0W06 2X5K6 J 0404	2x5k6	~
R717	1620105	Top	N	7	MNR02_SR	RES NETWORK 0W06 2X2K2 J 0404	2x2k2	~
R725	1430730	Top	P	6	0402R	Resistor 5% 63mW	150R	~
R726	1430730	Top	Q	6	0402R	Resistor 5% 63mW	150R	~
R731	1620507	Top	Q	9	0404_RAC10	RES NETWORK 0W04 3DB ATT 0404	292R/ 17R6/ 292R	~
R732	1430708	Top	P	6	0402R	Resistor 5% 63mW	18R	~
R733	1430708	Top	Q	6	0402R	Resistor 5% 63mW	18R	~
R801	1430770	Top	U	4	0402R	Resistor 5% 63mW	4k7	~

Item	Code	Side	Grid	Ref	Type	Description and value		
R802	1430754	Top	U	3	0402R	Resistor 5% 63mW	1k0	~
R803	1430718	Top	T	4	0402R	Resistor 5% 63mW	47R	~
R817	1430754	Top	U	8	0402R	Resistor 5% 63mW	1k0	~
R818	1430718	Top	T	8	0402R	Resistor 5% 63mW	47R	~
R820	1430754	Top	T	8	0402R	Resistor 5% 63mW	1k0	~
R821	1430718	Top	T	8	0402R	Resistor 5% 63mW	47R	~
R822	1430762	Top	T	8	0402R	Resistor 5% 63mW	2k2	~
R823	1430700	Top	T	8	0402R	Resistor 5% 63mW	10R	~
R824	1430754	Top	T	8	0402R	Resistor 5% 63mW	1k0	~
R826	1430726	Top	U	8	0402R	Resistor 5% 63mW	100R	~
R827	1430726	Top	U	8	0402R	Resistor 5% 63mW	100R	~
R828	1430722	Top	U	8	0402R	Resistor 5% 63mW	68R	~
R833	1430700	Top	T	8	0402R	Resistor 5% 63mW	10R	~
R890	1620505	Top	S	8	0404_RAC10	RES NETWORK 0W04 2DB ATT 0404	436R/ 11R6/ 436R	~
S130	5209001	Bottom	V	7	BUTTON_EVQP UA02	SM SW TACT SPST 12V 50MA SIDE KEY	~	~
T701	4550191	Top	Q	5	TRANS_LDB21 3	TRANSF BALUN 1800+-100MHZ 2X1.25	~	~
T702	4550187	Top	R	9	TRANS_LDB21 3	TRANSF BALUN 3600MHZ+- 400MHZ	~	~
V130	4110473	Top	P	2	SOD_523	SCH DI 30V 200MA VF 0V5 SOD523	~	~



Item	Code	Side	Grid	Ref	Type	Description and value		
V131	4219919	Top	N	2	EM3	TR PDTA114EE RB=RBE=10K 50V SC75	~	~
V132	4129061	Top	J	3	FC6_1.65X1.15	ASIP 2-CH MIC EMI/ESD **PB- FREE**	~	~
V165	4219937	Top	L	9	SOT_363	TRX2 UMT1/ PUMT1 P40V100MA SOT363	~	~
V380	4113721	Bottom	M	8	CASE_457	TVS DI 1PMT16AT3 16V 175W PWRMITE	~	~
V601	4210100	Top	N	4	SOT323	Tr NPN 30V 100mA 100MHz SOT323	~	~
V801	4115821	Top	U	4	SOT323_H1.1	SCHDIX2 HSMS282C 15V <1PF SOT323	~	~
V802	4210197	Top	T	8	SC75	TR NE68119 N 7GHZ LNA NF<1.8 SC75	~	~
X130	5469217	Top	N	9	CONN_R0923_ 22	SM CONN 2X11 SPR 50V 0.5A PCB/ PCB	~	~
X131	5469219	Top	I	2	JST_R_JAVK_G _1_R3	SM CONN 2X12F P0.4 30V 0.3A PCB/PCB	~	~
X132	5400247	Bottom	F	8	CONTACT_PAD _2.95X1.95	SM CONN VIBRA SPACER PAD 2.8X1.8	~	~
X133	5400247	Bottom	F	9	CONTACT_PAD _2.95X1.95	SM CONN VIBRA SPACER PAD 2.8X1.8	~	~
X382	5409253	Bottom	Q	2	LYNX_BATT_C ONN	SM BATTERY CONN 3POL SPR 12V 2A	~	~
X469	5409317	Bottom	H	4	SIM_READER_ M_C707	SM SIM CONN 2X3POL P2.54MM	~	~
X471	5400339	Bottom	N	4	CONN_MMC_ C75_1303	MMC CONNEC- TOR D TYPE P1831	~	~
Z130	4129035	Top	J	2	uBGA25_2.69X 2.69	ASIP 10-CH ESD EMI FILTER BGA25	~	~

Item	Code	Side	Grid	Ref	Type	Description and value		
Z300	3203741	Top	L	7	0603_BLM	FERRITE BEAD OR5 600R/100MHZ 0603	600R/ 100MH z	~
Z301	3203741	Top	L	8	0603_BLM	FERRITE BEAD OR5 600R/100MHZ 0603	600R/ 100MH z	~
Z302	3203741	Top	K	8	0603_BLM	FERRITE BEAD OR5 600R/100MHZ 0603	600R/ 100MH z	~
Z601	4550255	Top	T	3	ANT_SW_LMZ 0170A	ANT.SW 824-894/ 1850-1990MHZ	~	~
Z603	4511325	Top	Q	5	FILTER_SAW_S X_B195E	SAW FILT 1960+- 30MHZ/4DB 2.5X2.0	1960M Hz	~
Z604	4511323	Top	Q	4	FILTER_SAW_S AFSD	SAW FILT 881.5+- 25MHZ 3DB 2.5X2.0	881.5M Hz	~
Z701	4511317	Top	P	7	FILTER_SAW_S AFSD	SAW FILT 836.5+- 12.5MHZ/2.5DB 2520	836.5M Hz	~

Component layout diagram - bottom

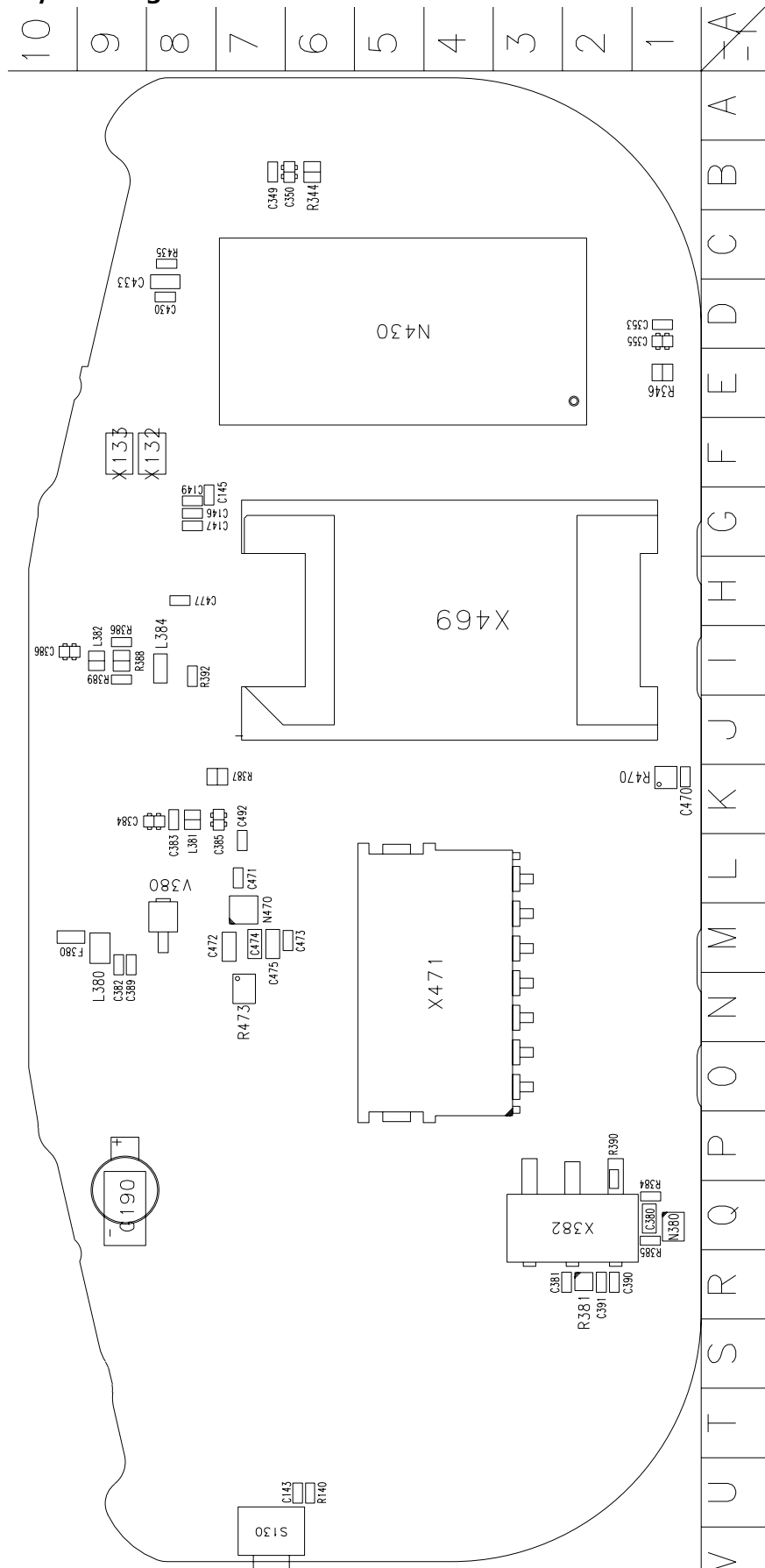

Component layout diagram - top

